

# COMPRESSED AIR FILTER MADE OF PLASTIC

F035 ... F095

<b>Description</b>	Filter of modular design which can be interlocked with all other instruments of the same series without need for double nipples. The flow on standard filters is from outside to inside; on coalescing filters 0.1 µm from inside to outside.	
<b>Filter element</b>	5 µm, 20 µm, 80 µm made of sintered polyethylene, 160 µm made of stainless steel, 0.01 µm coalescing filter made of borosilicate and activated carbon filter	
<b>Filtration efficiency</b>	coalescing filter: 99.99% at 0.01 µm particle size,	residual oil content < 5 mg/m <sup>3</sup>
<b>Bowl</b>	plastic version with bayonet catch,	type 042 with connection thread
<b>Drainage</b>	manual drain in conjunction with semiautomatic drain, optionally automatic drain, no drain for water	
<b>Operating pressure</b>	max. 7 bar at series 035, max. 16 bar at series 042, max. 12.5 bar at series 050 to 095	
<b>Temperature range</b>	0 °C to 50 °C / 32 °F to 122 °F	
<b>Material</b>	Body: nylon, POM at types 035 and 042 Bowl: polyamide	Elastomer: NBR/Buna-N Inner valve: brass

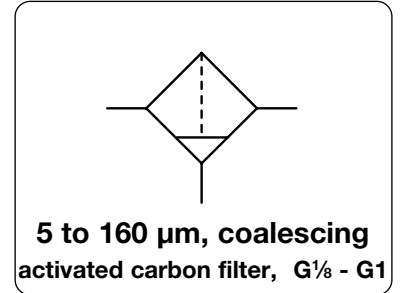

Dimensions			Bowl	Flow	P <sub>1</sub>	Filter	Connection	Order
A	B	C	Design	Capacity	rate	max.	element	thread
mm	mm	mm		l	m <sup>3</sup> /h*1	l/min*1	µm	G

Compressed air filter			manual drain with semiautomatic drain, 99.99% at 0.01 µm				F0			
38	79	67	plastic	0.008	45	750	7	20	G <sup>1</sup> / <sub>8</sub>	<b>F035-01H</b>
			plastic		40	670		5		<b>F035-01G</b>
			for water w/o drain		50	830		80		<b>F035-01J</b>
			coalescing		7	115		0.01		<b>F035-01C</b>
42	146	126	plastic	0.02	75	1250	16	20	G <sup>1</sup> / <sub>4</sub>	<b>F042-02H</b>
			plastic		63	1050		5		<b>F042-02G</b>
			for water w/o drain		79	1320		80		<b>F042-02J</b>
			for water w/o drain		87	1450		160		<b>F042-02K</b>
			coalescing		11	180		0.01		<b>F042-02C</b>
52	174	148	bowl guard	0.04	150	2500	12.5	20	G <sup>3</sup> / <sub>8</sub>	<b>F050-03H</b>
					126	2100		5		<b>F050-03G</b>
					16	500		0.01		<b>F050-03C</b>
					150	2500		activated carbon		<b>F050-03A</b>

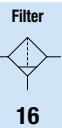

Series	D	ØE	F	K	L
<b>F035</b>	8.5	3.5	20	-	36
<b>F042</b>	10.5	4.5	31	-	42
<b>F050</b>	16.0	5.5	41	63	52

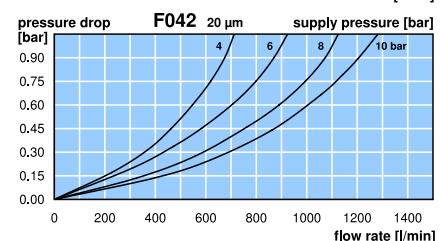
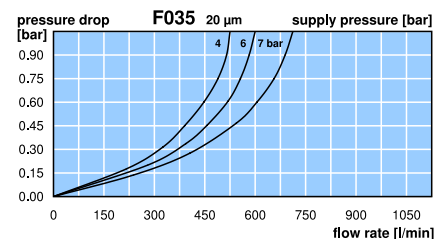
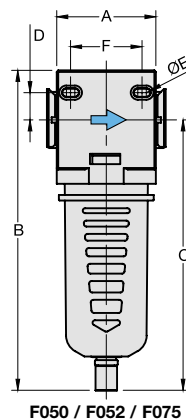
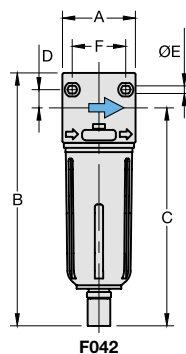
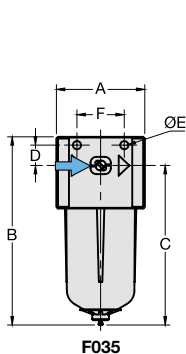
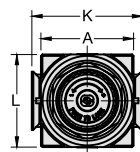

\*1 at 10 bar operating pressure and 1 bar pressure drop, for F035 and filter element 0.01 µm only 7 bar operating pressure

Extensions: see chapter for FRL service units

PDF CAD  
www.aircom.net



Order example:  
**F035-01H**

# COMPRESSED AIR FILTER MADE OF PLASTIC

F035 ... F095

<b>Description</b>	Filter of modular design which can be interlocked with all other instruments of the same series without need for double nipples. The flow on standard filters is from outside to inside; on coalescing filters 0.1 µm from inside to outside.	
<b>Filter element</b>	5 µm, 20 µm, 80 µm made of sintered polyethylene, 160 µm made of stainless steel, 0.01 µm coalescing filter made of borosilicate and activated carbon filter	
<b>Filtration efficiency</b>	coalescing filter: 99.99% at 0.01 µm particle size,	residual oil content < 5 mg/m <sup>3</sup>
<b>Bowl</b>	plastic version with bayonet catch,	type 042 with connection thread
<b>Drainage</b>	manual drain in conjunction with semiautomatic drain, optionally automatic drain, no drain for water	
<b>Operating pressure</b>	max. 7 bar at series 035, max. 16 bar at series 042, max. 12.5 bar at series 050 to 095	
<b>Temperature range</b>	0 °C to 50 °C / 32 °F to 122 °F	
<b>Material</b>	Body: nylon, POM at types 035 and 042 Bowl: polyamide	Elastomer: NBR/Buna-N Inner valve: brass

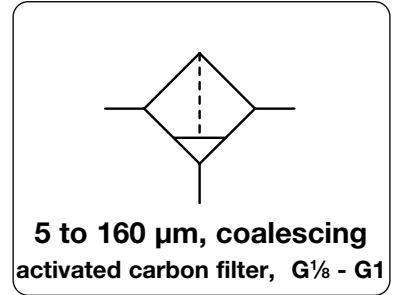

Dimensions			Bowl	Flow	P <sub>1</sub>	Filter	Connection	Order
A	B	C	Design	Capacity	rate	max.	element	thread
mm	mm	mm		l	m <sup>3</sup> /h*1	l/min*1	µm	G

Compressed air filter			manual drain with semiautomatic drain, 99.99% at 0.01 µm				F0			
52	174	148	bowl guard	0.04	156	2600	12.5	20	G <sup>1</sup> / <sub>2</sub>	<b>F052-04H</b>
					132	2200		5		<b>F052-04G</b>
					17	500		0.01		<b>F052-04C</b>
					156	2600		activated carbon		<b>F052-04A</b>
63	204	173	bowl guard	0.10	186	3100	12.5	20	G <sup>1</sup> / <sub>2</sub>	<b>F075-04H</b>
					165	2750		5		<b>F075-04G</b>
					18	800		0.01		<b>F075-04C</b>
					186	3100		activated carbon		<b>F075-04A</b>
137	204	173	bowl guard	0.10	192	3200	12.5	20	G <sup>3</sup> / <sub>4</sub>	<b>F080-06H</b>
					168	2800		5		<b>F080-06G</b>
					18	800		0.01		<b>F080-06C</b>
95	284	237	bowl guard	0.20	828	13800	12.5	20	G <sup>1</sup>	<b>F095-08H</b>
					750	12500		5		<b>F095-08G</b>



**Special options,** add the appropriate letter  
 automatic drain C400200130 for F042 to F095 F0. . - 0 . . R

**Accessories,** enclosed  
 mounting bracket set made of steel for F095 **BW00-02**

Series	D	Ø E	F	K	L
<b>F052</b>	16.0	5.5	41	63	52
<b>F075</b>	17.5	5.5	45	75	63
<b>F080</b>	17.5	5.5	45	-	63
<b>F095</b>	-	-	-	115	95

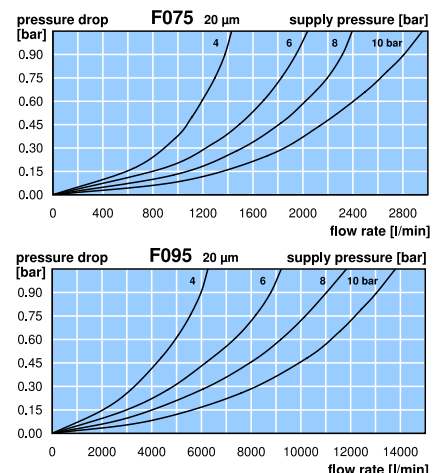
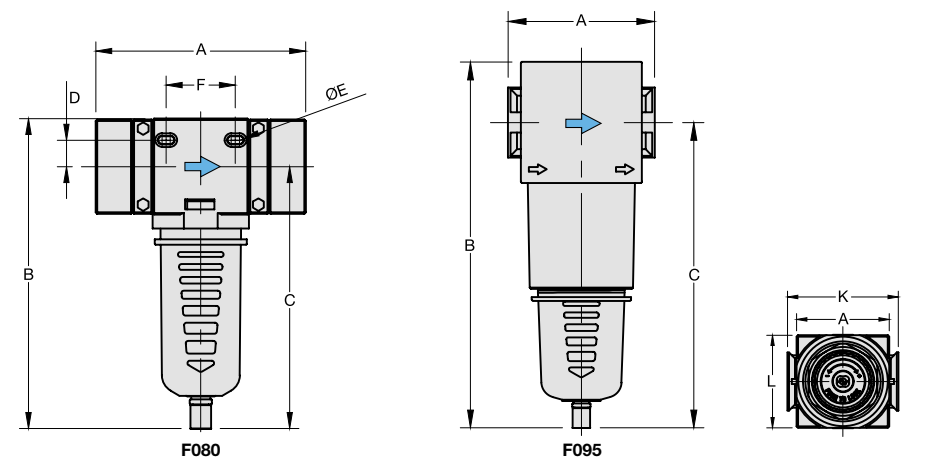

\*1 at 10 bar operating pressure and 1 bar pressure drop, for F035 and filter element 00.1 µm only 7 bar operating pressure